

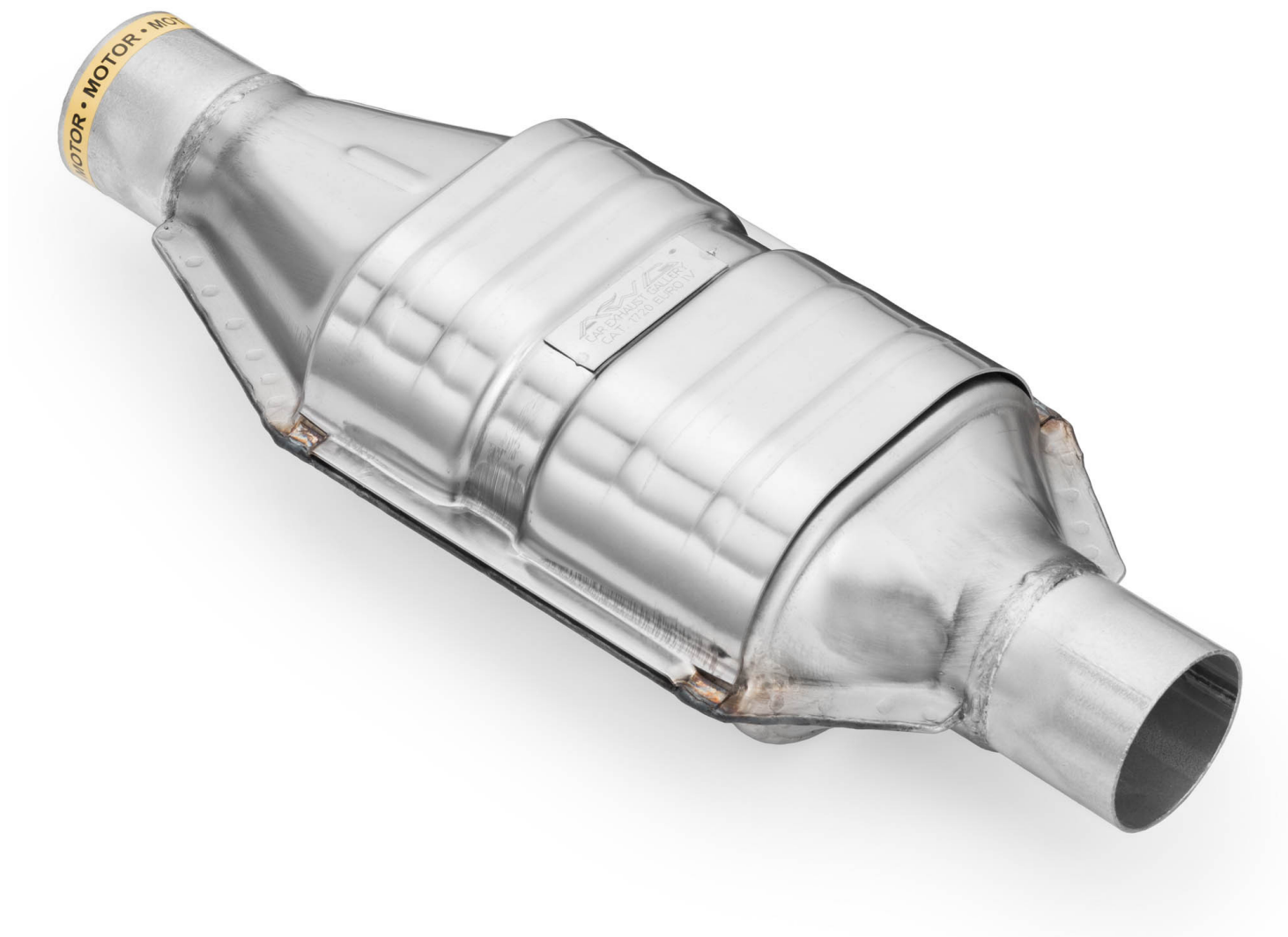

Universal ceramic catalytic converter 1.6-2.0L gasoline



Product codes:

Reference: CP20

EAN13: -



Product features:

Catalyst application: Gasoline
Cartridge type: Standard
Cartridge material: Ceramic
Producer: AWG Polonez
Total length: 385 mm
Engine capacity: 1.6-2.0L
Shape of the catalyst: flat
Width of catalyst: 152 mm
Height of catalyst: 95 mm

Product attributes:

euro standard: Euro 2, Euro 3, Euro 4
Inlet pipe diameter: 50 mm, 55 mm
Capacity (cpsi): 400

Product description:

Universal stainless steel catalytic converter with ceramic cartridge. Compatible with gasoline engines.

Depending on the emission standard, the catalyst has the following capacities:

Euro 2 - 400 cpsi

Euro 3 - 400 cpsi

Euro 4 - 400 cpsi

Euro 5 - 500 cpsi

Euro 6 - 600 cpsi

Not recommended for LPG installations.

If you own a car with a gas installation or are planning to install one, opt for a catalytic converter with a metal insert.

The product has the following certificates and approvals:

- European approval (E24, E9, E3)
- ISO 9001 Quality Management System certificate for the design of production and sale of automotive catalytic converters issued by TUV SUD in Munich.

The catalytic converter meets the requirements of the European Directive:

- EURO 2 Directive 94/12/EC, 96/69/EC for passenger cars, in force since 1996.



-
- EURO 3 Directive 98/69/EC [12] for all vehicles, effective since 2000
 - EURO 4 Directive 98/69/EC, 2002/80/EC for all vehicles, effective from 2005.
 - EURO 5 Directive 2007/715/EC[13] for light passenger and company cars. In force since 2009.
 - EURO 6 Commission Regulation (EU) No. 459/2012. in effect since 2014.

Manufacturer's warranty: 12 months or 50,000 km.